

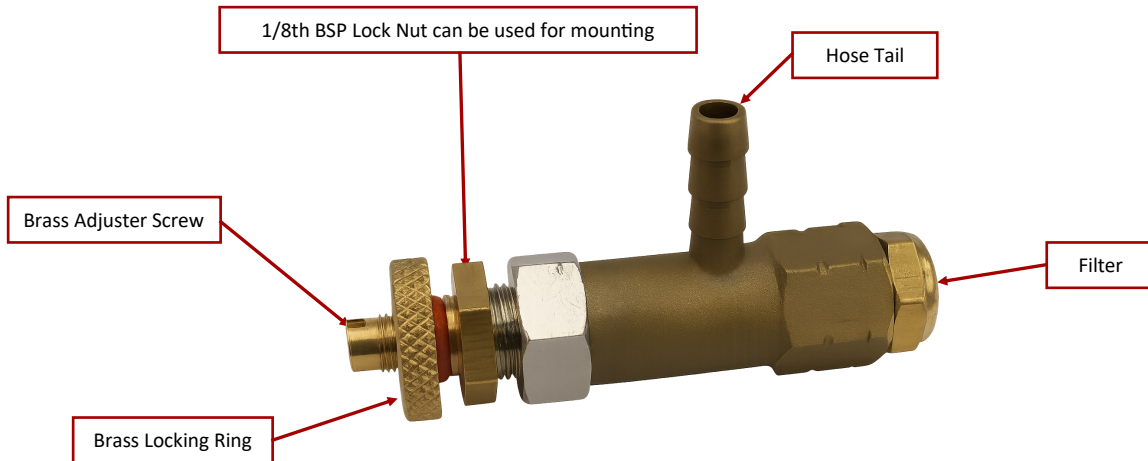

Railways

PNR 1H - Vacuum Limiting Valve

Operating Instructions



The vacuum limiting valve can be adjusted to set a limit of vacuum to the system in which it is installed. When this pre-set limit has been reached air is allowed to enter the system, thus maintaining the pre-set limit.

Mounting Suggestion

1. Mount the valve with a small saddle or similar, leaving access to the brass adjuster screw. Remove the adjuster 'o' ring and lock nut to mount.
2. Check the valve and settings at regular intervals.

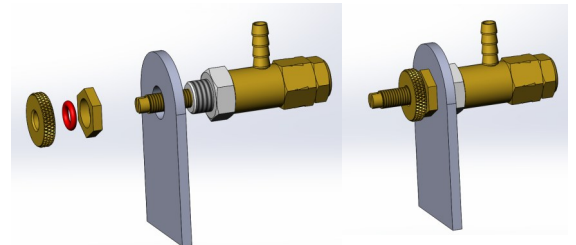

Connection

This valve is fitted with a filter to eliminate the risk of dirt or foreign bodies being drawn into the system.

1. Slacken the brass locking ring at the opposite end of the limit valve.
2. Fully unscrew the brass adjuster screw to the limit.
3. Put the vacuum pipe onto the hose tail, and attempt to generate vacuum.
4. Observe vacuum gauge, which should be reading a small number.
5. Start to screw in brass adjuster screw until desired vacuum level is reached.
6. Finally lock up brass locking ring. Finger tight is sufficient to keep the brass screw in position.

Note

This product must not be used for any other purpose than the one described. Its function and condition should be checked regularly.